

VICINITY MAP

KEY NOTES

- (A) 20' X 45' COMPRESSOR BUILDING
- (B) 20' X 30' BOILER BUILDING
- (C) 20' X 40' FILTER BUILDING
- (D) 30' X 180' OFFICE BUILDING
- (E) 12' X 30' ELECTRICAL SERVICE BUILDING
- (F) 17' X 33'-1" CHILLER PAD
- (G) 14' X 80' SUPERVISOR OFFICE BREAK ROOM, REST ROOM
- (H) 14' X 90' SUPERVISOR OFFICE RECEIVING CLERK'S OFFICE, BREAK ROOM & REST ROOM
- (I) 8' X 13' REST ROOM
- (J) 14' X 60' SUPERVISOR OFFICE, BREAK ROOM & JANITORS CLOSET
- (K) 8' X 13' REST ROOM
- (L) 8' X 13' REST ROOM
- (M) 30' X 75' OFFICE AREA
- (N) 15' R. WATER TANK
- (O) 10' X 12' OFFICE
- (P) 10' X 12' FIRE PUMP ROOM
- (Q) WELL SYSTEM
- (R) WATER STORAGE TANK

LEGEND

- PROPERTY LINE
- CENTERLINE
- RIGHT OF WAY LINE
- NEW ASPHALT
- NEW AGGREGATE BASE COARSE (ABC)
- NEW AGGREGATE BASE COARSE (ABC) WITH MAGNESIUM CHLORIDE
- NEW EARTH BERM
- EXISTING AC PAVEMENT
- CONCRETE SYMBOL
- FOUND MONUMENT-TYPE AS SHOWN
- SET MONUMENT-TYPE AS SHOWN
- Ⓜ BUILDING KEY

NOTES

1. ALL DIMENSIONS HEREON TO THE OUTSIDE FACE OF BUILDING OR EDGE OF CONCRETE, ABC OR ASPHALT.
2. REFER TO BOUNDARY AND TOPOGRAPHIC SURVEY (SHEET C-4) FOR ALL BOUNDARY AND TOPOGRAPHIC INFORMATIONS.
3. REFER TO ARCHITECTURAL, FOUNDATION AND BUILDING PLANS FOR EXACT DIMENSIONS AND DETAILS.

Dec. 26, 1997

**MEADOWCRAFT WAREHOUSE
YUMA COUNTY, ARIZONA**

SITE PLAN

SCALE: 1" = 60' DESIGNED BY: N.K.E. SURVEYED BY: J.M.G.
DATE: OCTOBER '97 DRAWN BY: L.H.G. JOB No. 97-038

EDAIS Engineering
3075 S. Ave. 4E Yuma, Arizona 85365
(520) 344-3666 FAX (520) 341-1075

C-1

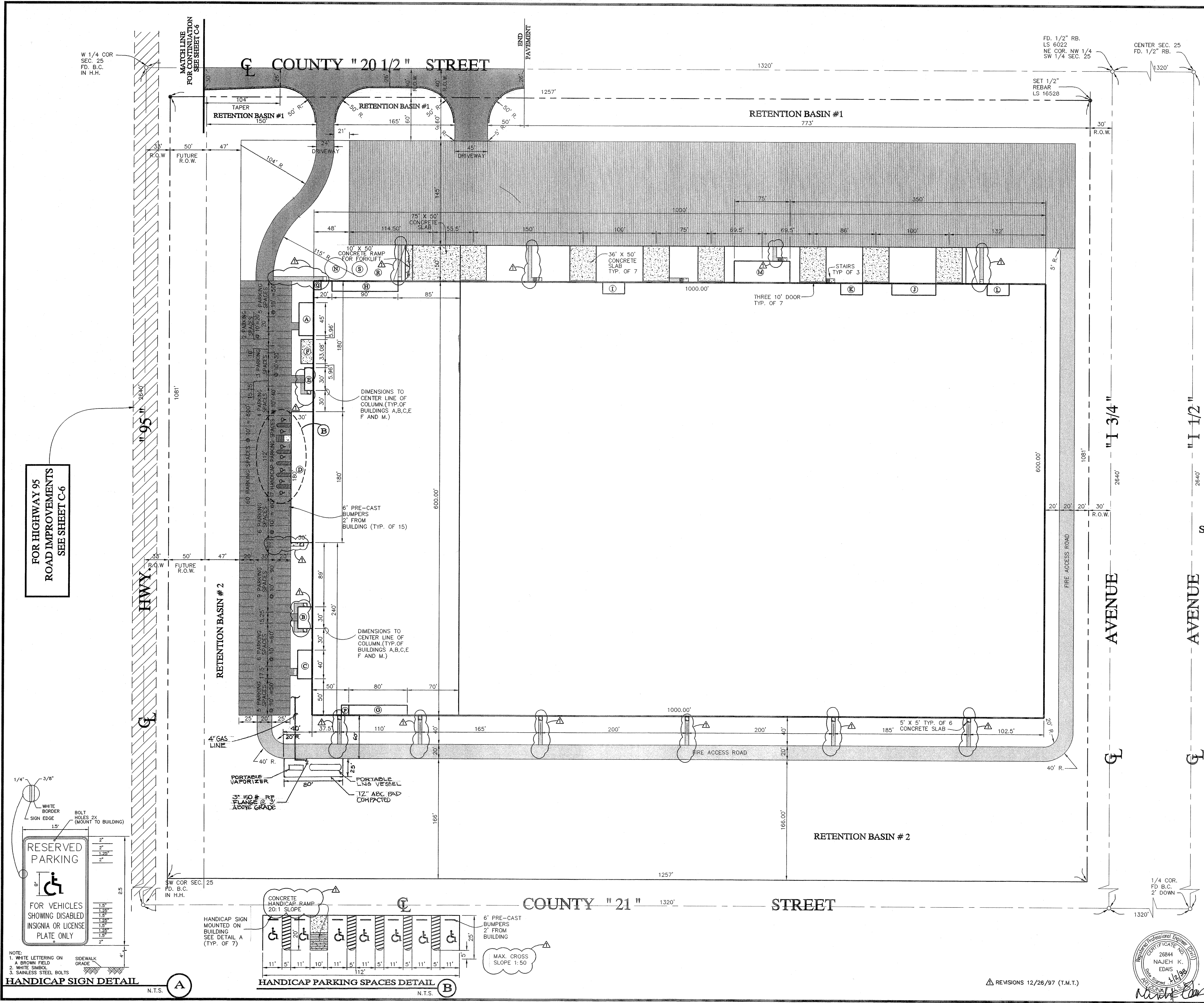

FOR HIGHWAY 95 ROAD IMPROVEMENTS SEE SHEET C-6

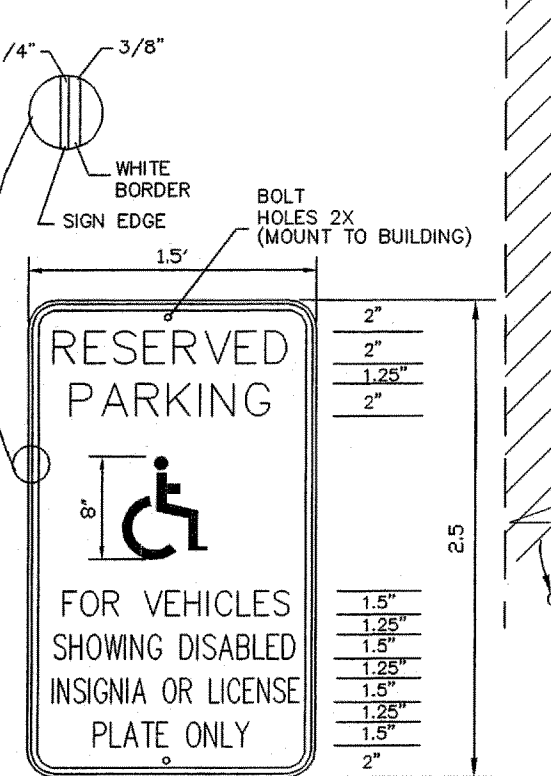

HANDICAP SIGN DETAIL
N.T.S. (A)

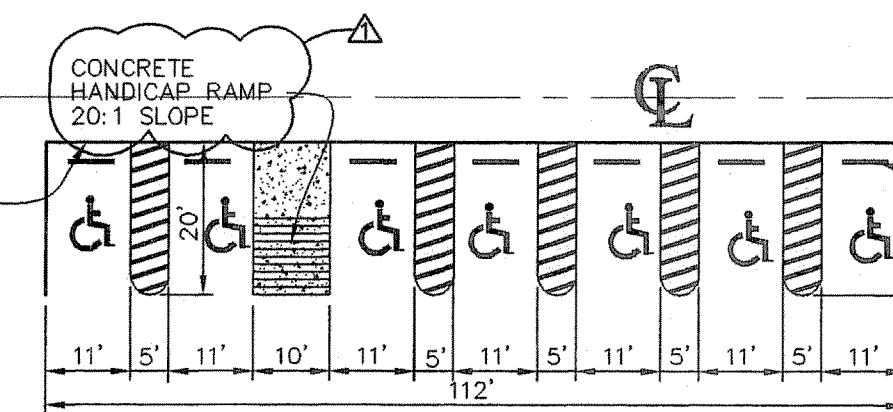

HANDICAP PARKING SPACES DETAIL
N.T.S. (B)

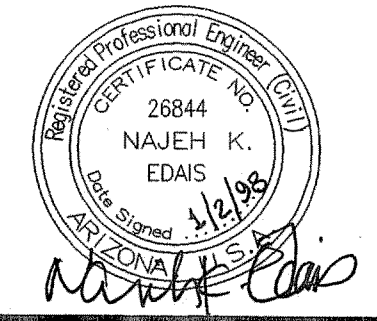

REVISIONS 12/26/97 (T.M.T.)